

12/20/2021 1:56:27 PM

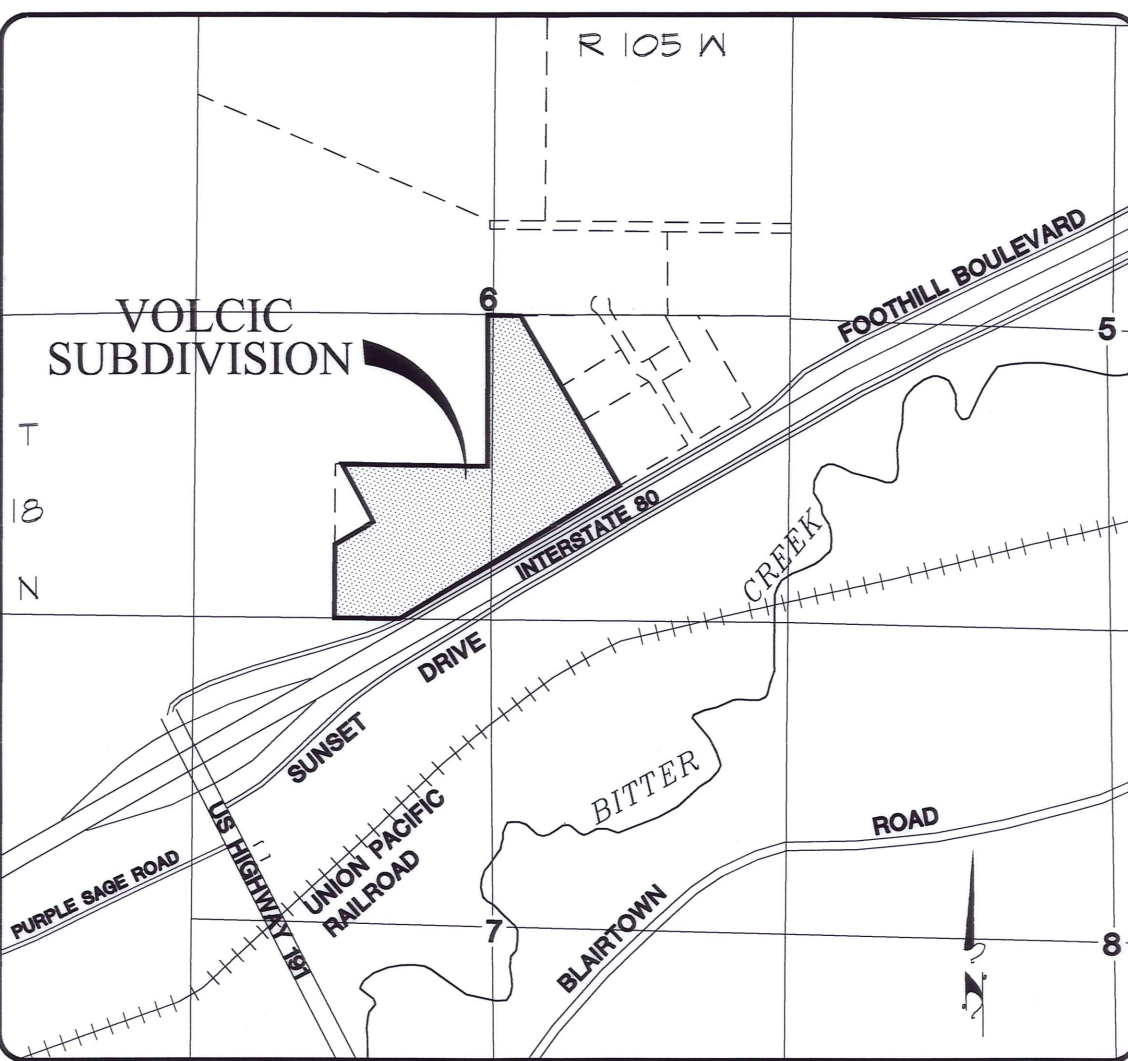

VICINITY MAP
Scale: 1"=2000'

KEYED NOTES FOR EASEMENTS/AGREEMENTS

- 1 20' SEWER LINE EASEMENT (BK 809, PG 316)
2 30' ELECTRIC EASEMENT (BK 234, PG 323)
3 25' WATER EASEMENT (BK 928, PG 1696)
4 ELECTRIC EASEMENT CL PLOTTED, NO WIDTH (BK 402, PG 137)
5 15' GAS LINE EASEMENT (BK 1218, PG 982)
6 ELECTRIC CL PLOTTED, NO WIDTH (BK 555, PG 162)
7 15' GAS LINE EASEMENT (BK 560, PG 30)
8 TELEPHONE EASEMENT, NO WIDTH (BK 792, PG 1070)
9 UTILITY USE AGREEMENT (BK 1218, PG 719)
10 UTILITY USE AGREEMENT BK 1243, PG 2715
11 TELEPHONE EASEMENT, NO WIDTH (BK 537, PG 637)
12 ACCESS EASEMENT (BK 1218, PG 715) - GREYED AREA IS PAVEMENT SURFACE AS DESCRIBED IN THE EASEMENT

ACCEPTANCE and APPROVAL
SWEETWATER COUNTY BOARD OF COMMISSIONERS

This plat approved by the Board of County Commissioners of Sweetwater County, Wyoming, this 22 day of December, 2021, for filing with the Clerk and Recorder of Sweetwater County, and for conveyance to the County of the public dedications shown hereon...

Dated this 22 day of December, 2021.

Signature of Randolph M. Wendling (Chairman)

APPROVAL - SWEETWATER COUNTY
PLANNING & ZONING COMMISSION

This plat approved by the Sweetwater County Planning & Zoning Commission this 22 day of December, 2021.

Signature of Angela Wilson (Chairman)

CERTIFICATE OF SURVEYOR

I, Geno G. Ferrero, do hereby certify that I am a Land Surveyor registered under the laws of the State of Wyoming, and that this plat is a true, correct, and complete plat of the VOLCIC SUBDIVISION...

GENO G. FERRERO
Professional Land Surveyor
Registration Number 12787



STATE OF WYOMING } SS
SWEETWATER COUNTY }

The foregoing instrument was acknowledged before me this 21st day of DECEMBER, 2021 by Geno G. Ferrero, as a free and voluntary act and deed.

Signature of Fran Romango (Notary Public)

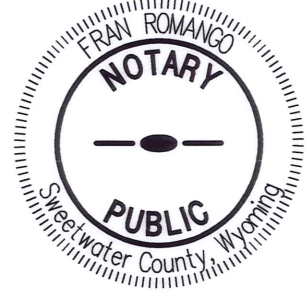

My commission expires: 10-10-2027

APPROVAL - COUNTY ENGINEER

Approved this 22 day of December, 2021 by the County Engineer of Sweetwater County, Wyoming.

Signature of Gene Legerski (Sweetwater County Engineer)

LOT 3
0.77 ACRES
33,481.91 SQ. FT.

LEGEND

- 3-1/4" BERNTSEN ALUMINUM CAP WITH 2-3/8"x30" ALUMINUM PIPE STAMPED "VOLCIC SUBDIVISION (CORNER # INDICATED ON PLAT) PLS 12787"
INDIVIDUAL LOT CORNERS TO BE MONUMENTED WITH A 5/8" REBAR WITH 2.5" ALUMINUM CAP STAMPED "PROPERTY CORNER JFC PLS 12787"
FOUND 2.5" ALUMINUM CAP ON A 5/8" REBAR STAMPED "PROPERTY CORNER JFC PLS 2928"

SUBDIVISION VARIANCES

- VARIANCE - RESOLUTION 21-10-ZO-06 DATED 10/19/2021
ZMA - RESOLUTION 21-10-ZO-07 DATED 10/19/2021
PRELIMINARY PLAT - P&Z AUTHORIZATION 21-10-PZ-01 DATED 10/13/2021

FINAL PLAT

VOLCIC SUBDIVISION
SECTION 6, RESURVEY T18N, R105W, 6th P.M.
SWEETWATER COUNTY, WYOMING

CERTIFICATE OF JOINDER

The undersigned, being an Owner of Interest in the Land Presently Being Platted as the Volcic Subdivision, do hereby ratify and join in all provisions of the Certificate of Dedication attached to said Plat as fully and completely as if we had executed the original Certificate of Dedication.

We do specifically dedicate the use of the streets, easements and public areas to the General Public.

STATE BANK
300 CENTER STREET
ROCK SPRINGS, WYOMING 82901

Signature of Pete DeLaRante
PETE DELAURANTE, EVP/CCO

STATE OF WYOMING } SS
SWEETWATER COUNTY }

The foregoing instrument was acknowledged before me this 21st day of DECEMBER, 2021

by PETE DELAURANTE, as a free and voluntary act and deed.

Witness my hand and official seal.

Signature of Fran Romango (Notary Public)

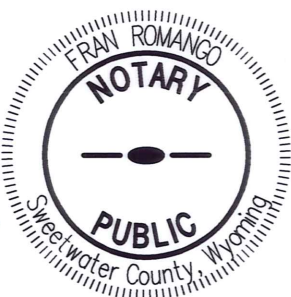

My commission expires: 10-10-2027

LOT 2
34.08 ACRES
1484,445.26 SQ. FT.

LOT 1
30.75 ACRES
1,338,421.03 SQ. FT.

Interstate Highway 80
SUNSET BOULEVARD
FOOTHILL BOULEVARD

APPROVAL - ROCK SPRINGS CITY COUNCIL

Approved by the City Council of the City of Rock Springs, Wyoming,

this 22 day of DEC, A.D., 20 21

Signature of Timothy A. Kaymo (Mayor)
Signature of Matt Burnett (City Clerk)

CERTIFICATE OF RECORDING

This plat was filed for record in the Office of the County Clerk and Recorder at 2:43 o'clock P.m., December 22, 2021, and is duly recorded on Page No. 601 in the Book of Plats.

Signature of Cynthia L. Lane (Clerk and Recorder)
Signature of Jennifer Wilder (Deputy)

PROPERTY OWNER

ROBERT A. VOLCIC
PO BOX 666
ROCK SPRINGS, WY 82902

