

CONDOMINIUM MAP - BUILDINGS "A", "B" AND "C"

A PARCEL LOCATED IN THE NE1/4 OF THE NW1/4 OF SECTION 3,
T. 18 N., R.105 W., OF THE SIXTH PRINCIPAL MERIDIAN,
SWEETWATER COUNTY, WYOMING

RECORDED 8-07-2009 AT 04:00 PM REC# 1562477 BK# 0080 PG# 0007
STEVEN DALE DAVID, CLERK OF SWEETWATER COUNTY, WYOMING 4 of 8

COMMERCE CENTRE - CONDOMINIUM MAP		
BUILDING "A"	0.515 ACRES	5 UNITS
BUILDING "B"	0.098 ACRES	1 UNIT
BUILDING "C"	0.105 ACRES	2 UNITS

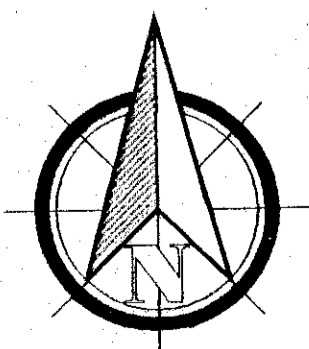
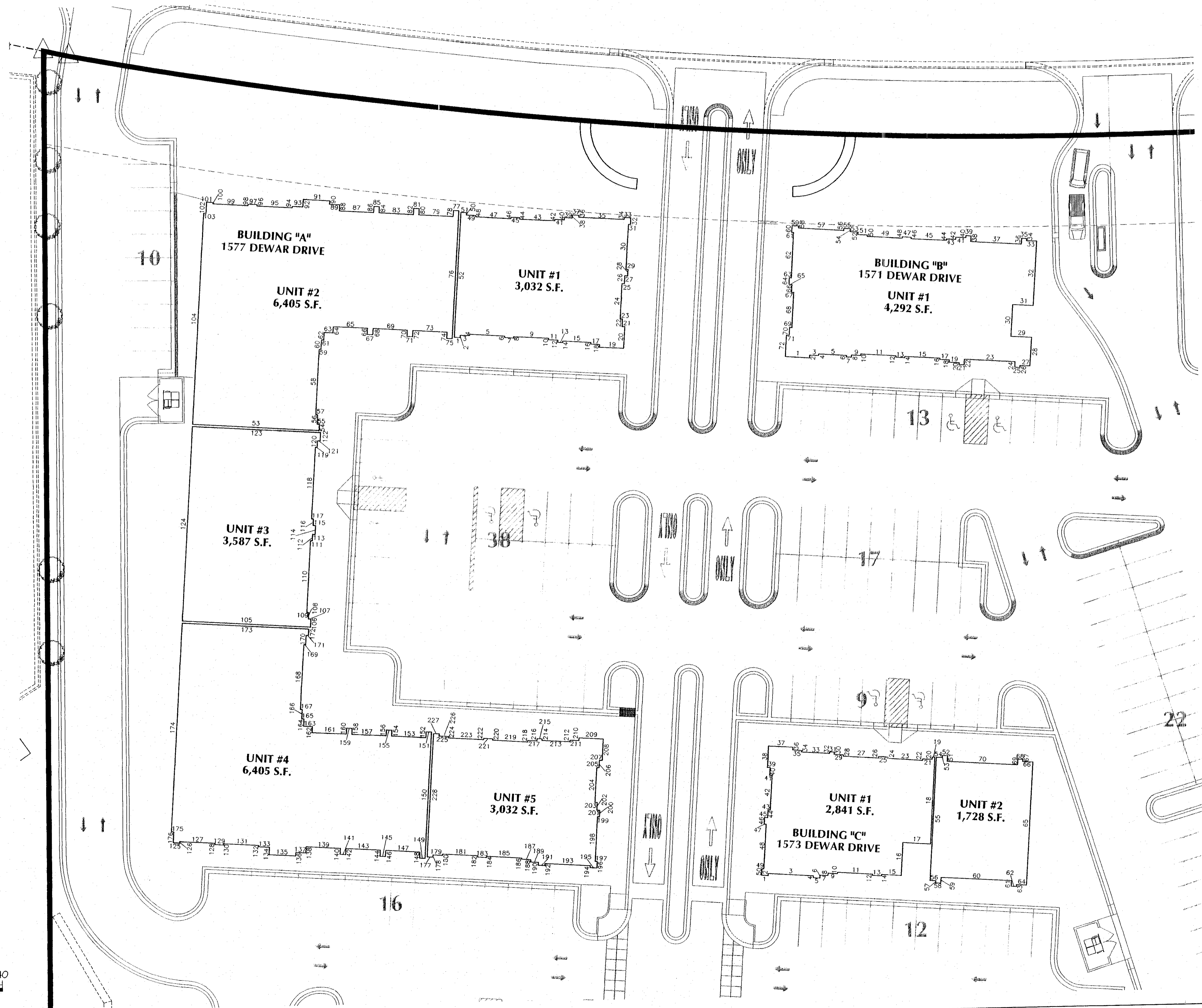

0 20 40
SCALE: 1" = 20'

CHOICE ENGINEERING SERVICES

404 "N" Street - Suite 201 | Rock Springs, WY 82901
Phone 307-362-6065 | Fax 307-362-6064

DATE OF PREPARATION: 07/31/09