



PHASE 1

LEGEND	
	PROPERTY LINE
	VINYL FENCE - 6FT. HIGH
	EDGE OF TURF/SHRUB BEDS
	FIRE HYDRANT
	STREET LIGHT (CITY STANDARD)
	PEDESTRIAN LIGHT (PRIVATE)
	PLAY STRUCTURE
	SWING-SET
	PLAYGROUND SAFETY SURFACING
	PICNIC TABLE W/ GRILL
	BENCH

PLANT LEGEND							
SYMBOL	BOTANICAL NAME	COMMON NAME					
EVERGREEN TREES							
	<i>Picea glauca densata</i>	Black Hills Spruce					
	<i>Picea pungens</i>	Colorado Spruce					
	<i>Pinus nigra</i>	Austrian Pine					
DECIDUOUS TREES							
	<i>Acer platanoides</i>	Norway Maple					
	<i>Celtis occidentalis</i>	Common Hackberry					
	<i>Fraxinus americana</i>	White Ash					
	<i>Fraxinus pennsylvanica</i>	Green Ash					
	<i>Gleditsia triacanthos inermis 'Shade Master'</i>	Shade Master Honeylocust					
	<i>Malus 'Red Baron'</i>	Red Baron Crab Apple					
	<i>Malus 'Spring Snow'</i>	Spring Snow Crab Apple					
	<i>Populus deltoides 'Siouxland'</i>	Siouxland Poplar					
	<i>Prunus virginiana 'Canada Red'</i>	Canada Red Chokecherry					
	<i>Quercus macrocarpa</i>	Burr Oak					
SHRUBS							
	<i>Amelanchier x grandiflora 'Princess Diana'</i>	Princess Diana Serviceberry					
	<i>Berberis thunbergii atropurpurea</i>	Red Leaf Barberry					
	<i>Berberis thunbergii atropurpurea 'Rose Glow'</i>	Rose Glow Barberry					
	<i>Eonymus alatus 'Compacta'</i>	Burning Bush					
	<i>Juniperus sabiniana 'Broadmoor'</i>	Broadmoor Juniper					
	<i>Pinus mugo</i>	Mugo Pine					
	<i>Potentilla fruticosa</i>	Shrubby Cinquefoil					
	<i>Prunus cistena</i>	Purple Sand Cherry					
	<i>Rhus glabra</i>	Smooth Sumac					
	<i>Syringa vulgaris</i>	Common Lilac					
	<i>Viburnum opulus 'Compactum'</i>	European Cranberry					
PERENNIALS/GROUNDCOVER/GRASSES							
	<i>Achillea 'Moonshine'</i>	Yarrow					
	<i>Coreopsis sp.</i>	Tickseed					
	<i>Echinacea sp.</i>	Purple Coneflower					
	<i>Helictotrichon sempervirens</i>	Blue Oak Grass					
	<i>Hemerocallis</i>	Daylily					
	<i>Iris sp.</i>	Siberian Iris					
	<i>Panicum virgatum 'Dallas Blues'</i>	Dallas Blues Switch Grass					
	<i>Panicum virgatum 'Shenandoah'</i>	Shenandoah Switch Grass					
	<i>Thymus serpyllum</i>	Mother of Thyme					
TURF							
	Chanshore Farms Drought Tolerant Blue Grass Blend (435) 854-3627						
SEED MIX - UPLAND							
	<i>Achnatherum hym.</i>	Indian Ricegrass	3.25		<i>Elymus trachycaulis</i>	Slender Wheatgrass	3.0
	<i>Dichelis spicata</i>	Indiana Salsgrass	0.5		<i>Poa serotena</i>	Sandberg Bluegrass	0.5
	<i>Elymus la. la.</i>	Thicket Wheatgrass	5.0		<i>Sporobolus aridus</i>	Alkali Sacaton	0.25
	<i>Elymus la. pan.</i>	Streambank Wheatgrass	5.0				
ROCK MULCH - Rock shall be Min. 4" Dia. and laid over weed control fabric							

- ### PLANTING NOTES
1. CONTRACTOR SHALL BE RESPONSIBLE FOR MAKING HIMSELF FAMILIAR WITH ALL UNDERGROUND UTILITIES, PIPES AND STRUCTURES. CONTRACTOR SHALL TAKE SOLE RESPONSIBILITY FOR ANY COSTS INCURRED DUE TO DAMAGE OF SAID UTILITIES.
 2. THE CONTRACTOR SHALL SUPPLY ALL PLANT MATERIAL IN QUANTITIES SUFFICIENT TO COMPLETE THE PLANTING SHOWN ON THE DRAWINGS. QUANTITIES ARE ESTIMATES, IT IS THE RESPONSIBILITY OF THE CONTRACTOR TO VERIFY THE NUMBERS.
 3. ANY PROPOSED SUBSTITUTIONS OF PLANT SPECIES SHALL BE MADE WITH PLANTS OF EQUIVALENT OVERALL FORM, HEIGHT, BRANCHING HABIT, FLOWER, LEAF, COLOR, FRUIT AND CULTURE ONLY AS APPROVED BY THE LANDSCAPE ARCHITECT.
 4. ALL PLANTED AREAS SHALL RECEIVE A 3" LAYER OF APPROVED BARK MULCH TO COVER ALL EXPOSED AREAS. SEE SPECIFICATIONS.
 5. ALL PLANT MATERIAL SHALL BE APPROVED BY THE OWNER'S REPRESENTATIVE UPON DELIVERY TO THE SITE, AND PRIOR TO INSTALLATION.
 6. FINAL LOCATIONS OF ALL PLANT MATERIALS SHALL BE SUBJECT TO APPROVAL OF THE OWNER'S REPRESENTATIVE.
 7. THE CONTRACTOR TO SUPPLY A MINIMUM OF 6" OF AMENDED TOPSOIL TO ALL NEW PLANTINGS. PRUNE TREES IN ACCORDANCE WITH SPECIFICATIONS. AMEND THE SOIL WITH ORGANIC MATERIAL AS PER SPECIFIC RECOMMENDATIONS OF THE SOILS REPORT. SCARIFY THE SOIL TO A MIN. DEPTH OF 6 INCHES.
 8. ALL PLANT MATERIALS SHALL MATCH SPECIFICATIONS PER SPECIES AND COMPLY WITH ANSI Z60.1 "STANDARDS FOR NURSERY STOCK."
 9. TREES SHALL NOT BE PLANTED LESS THAN 5'-0" FROM CURBS OR HARD SURFACE AREAS UNLESS A ROOT BARRIER IS INSTALLED PER SPECIFICATIONS.
 10. ALL MANUFACTURED SLOPE AREAS AND DRAINAGE SHALES SHALL BE COVERED WITHIN 30 DAYS OF COMPLETION OF GRADING WITH STRAW MULCH, JUTE NETTING, OR OTHER APPROVED GEOTEXTILE MATERIAL CAPABLE OF CONTROLLING SURFACE SOIL EROSION.
 11. ALL PARK STRIP LANDSCAPE IMPROVEMENTS SHALL BE MAINTAINED BY THE HOA TO ELIMINATE SITE DISTANCE PROBLEMS, SIDEWALK OBSTRUCTIONS, OR CONFLICTS WITH STREET PLOWING/SWEEPING AND MAINTENANCE.
 12. WALKING PATHS AND PERIMETER TRAIL SHALL BE MAINTAINED BY THE HOA.

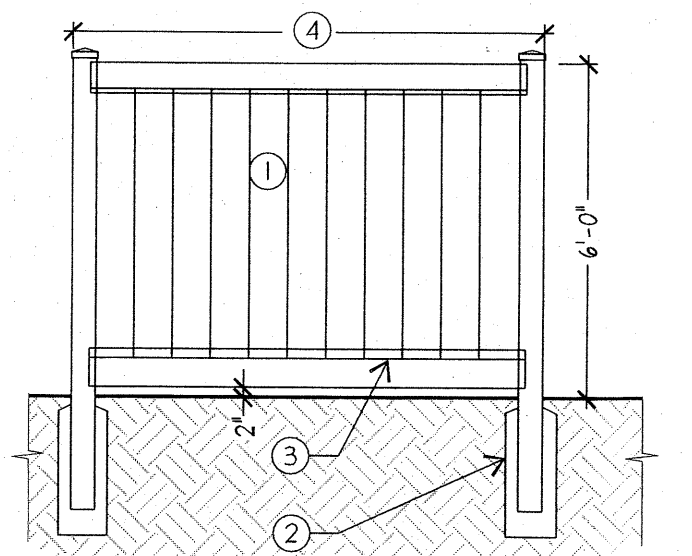
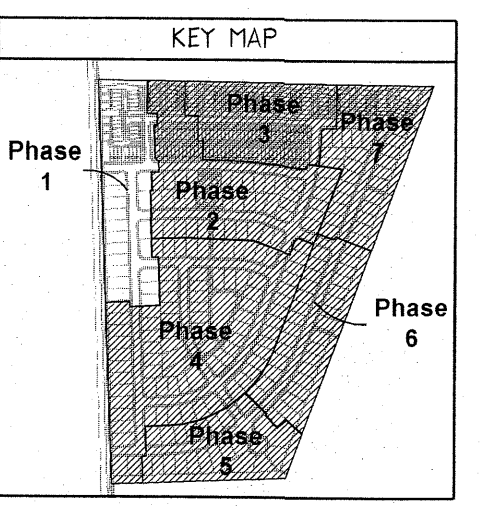

1. VINYL PRIVACY FENCE
 2. CONCRETE FOOTING PER MANUFACTURER'S SPECS., TYP.
 3. FINISH GRADE
 4. LENGTH VARIES- SEE PLANS
- NOTE:
1. INSTALLATION TO BE COMPLETED IN ACCORDANCE WITH MANUFACTURER'S SPECIFICATIONS.

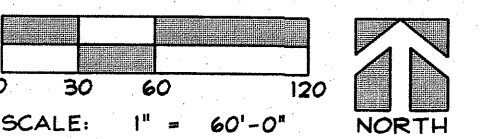

VINYL FENCE - 6FT. HIGH
SCALE: NTS
ELEVATION

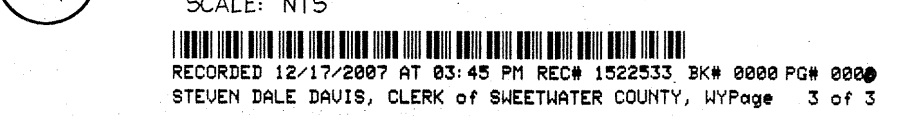

jsa architects

6465 s. 3000 e. suite 205
salt lake city utah 84121
801.733.2500 fax 801.733.2501

THE DESIGNS SHOWN AND DESCRIBED HEREIN INCLUDING ALL TECHNICAL DRAWINGS, GRAPHIC REPRESENTATION & MODELS THEREOF, ARE PROPRIETARY & CAN NOT BE COPIED, DUPLICATED, OR COMMERCIALY EXPLOITED IN WHOLE OR IN PART WITHOUT THE SOLE AND EXPRESS WRITTEN PERMISSION FROM JSA ARCHITECTS, LLC. THESE DRAWINGS ARE AVAILABLE FOR LIMITED REVIEW AND EVALUATION BY CLIENTS, CONSULTANTS, CONTRACTORS, GOVERNMENT AGENCIES, VENDORS, AND OFFICE PERSONNEL ONLY IN ACCORDANCE WITH THIS NOTICE.

consultant:
ArcSiti
Design, Inc
Landscape Architecture & Architectural Site Design

1058 East 2100 South
Salt Lake City, Utah 84108
office 801.487.4923
www.arcsitiodesign.com

stamp:

project:
MORNINGSIDE DEVELOPMENT

ROCK SPRINGS WYOMING

date
May 4, 2007

revisions

data
project number: 06045
plot date: 05/04/07
drawn by: ASD TEAM
checked by: RG

title
LANDSCAPE AND LIGHTING PLAN PHASE 1
sheet

L L1
SHEET 3 OF 3