

STATEMENT OF SURVEYOR

I, Craig A. Shavers do hereby certify that I am a Registered Professional Land Surveyor licensed under the laws of the State of Wyoming, that this plat is a true, correct, and complete plat of the QUINELLA SUBDIVISION as laid out, platted, dedicated, and shown hereon, that such plat was made from an accurate survey of said property by me and under my supervision and correctly shows the location and dimensions of the lots, easements, and streets of said subdivision as the same are staked upon the ground in compliance with the City of Rock Springs regulations governing the subdivision of land to an accuracy of one (1) part in ten thousand (10,000).

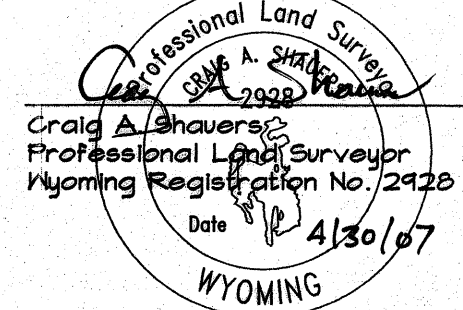

STATE OF WYOMING SS  
SWEETWATER COUNTY

The foregoing instrument was acknowledged before me this 30<sup>th</sup> day of APRIL, 2007, by:

Craig A. Shavers  
as a free and voluntary act and deed.

Witness my hand and official seal.

My commission expires: 10-10-09

*Susan Romango*  
Notary Public

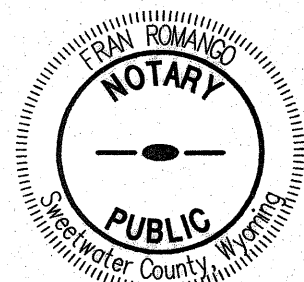

APPROVAL - PLANNING & ZONING COMMISSION

This plat approved by the City of Rock Springs Planning and Zoning Commission this 11<sup>th</sup> day of April, A.D., 2007.

*Zyg Samiec*  
ZYGMUNT SAMIEC, Chairman

*Laura Crandall*  
Attest:  
LAURA CRANDALL, Secretary

DECLARATION VACATING PREVIOUS PLATTING

This plat is the resubdivision of Lots 83, 84 and 85 of the Sweetwater Downs Subdivision, Phase 2 as recorded in the Book of Plats, Page 487, of the records of the Sweetwater County Clerk. All earlier plats or portions thereof, encompassed by the boundaries of this plat are hereby vacated.

ACCEPTANCE AND APPROVAL - ROCK SPRINGS CITY COUNCIL

Approved by the City Council of the City of Rock Springs, Wyoming, this 1<sup>st</sup> day of May, A.D., 2007.

*Timothy A. Kaulmo*  
TIMOTHY A. KAULMO, Mayor

*Lisa M. Taruffelli*  
Attest:  
LISA M. TARUFFELLI, City Clerk



# FINAL PLAT FOR QUINELLA SUBDIVISION

( A RESUBDIVISION OF LOTS 83-85 OF SWEETWATER DOWNS SUBDIVISION, PHASE 2 )

SECTION 28, RESURVEY TOWNSHIP 19 NORTH, RANGE 105 WEST  
ROCK SPRINGS, SWEETWATER COUNTY, WYOMING

CERTIFICATE OF DEDICATION

Know all men by these presents that the undersigned Carol Agostini, Trustee of the CAROL AGOSTINI REVOCABLE TRUST and DAVID M. PIAIA, being the owners, proprietors, or parties of interest in the land shown on this plat, does hereby certify:

That the foregoing plat designated as the QUINELLA SUBDIVISION is located in Federal Lot 2 of Section 28, Resurvey Township 19 North, Range 105 West of the Sixth Principal Meridian, Rock Springs, Sweetwater County, Wyoming, being a re-subdivision of Lots 83, 84 and 85 of the Sweetwater Downs Subdivision, Phase 2 as platted and filed in the office of the Sweetwater County Clerk and is more particularly described as follows:

Commencing at the southeast corner of said Lot 85;  
Thence North 87°49'05" West along the southerly boundary of said Lots 83, 84 and 85 for a distance of 254.31 feet to a point which is the beginning of a tangent curve to the right having a radius of 20.00 feet;  
Thence northwesterly along said curve through a central angle of 87°46'29" for an arc distance of 30.64 feet;  
Thence North 00°02'36" West along the westerly boundary of said Lot 85 for a distance of 80.84 feet to the northwest corner thereof;  
Thence South 87°49'05" East along the northerly boundary of said Lots 83, 84 and 85 for a distance of 277.44 feet to the northeast corner of said Lot 85;  
Thence South 02°10'55" West along the easterly boundary of said Lot 85 for a distance of 100.00 feet to the Point of Beginning.

and contains an area of 0.631 acres, more or less, and that this subdivision, as it is described and as it appears on this plat, is made with the free consent and in accordance with the desires of the undersigned owners and proprietors, and that this is a correct plat of the area as it is divided into lots, blocks, streets and easements, and that the undersigned owners of the land shown and described on this plat do hereby dedicate to the City of Rock Springs and its licensees for perpetual public use all streets, alleys, and easements for the purposes designated and other lands within the boundary lines of the plat as indicated and not otherwise dedicated for public use.

All rights under and by virtue of the homestead exemption laws of the State of Wyoming are hereby waived and released.

The above described tract lies within the Sweetwater Downs Subdivision, Phase 2 to the City of Rock Springs, Wyoming. It is our desire to VACATE the above described portion of the original plat in order that this new subdivision plat may be recorded in its place. We declare that the aforesaid portion of said original plat is hereby vacated, from and after the date of execution hereof.

Executed this 4<sup>th</sup> day of May, 2007, by:

CAROL AGOSTINI REVOCABLE TRUST

DAVID M. PIAIA

*Carol Agostini*  
Carol Agostini, Trustee

*David M. Piaia*

STATE OF WYOMING }  
SWEETWATER COUNTY } SS

STATE OF WYOMING }  
SWEETWATER COUNTY } SS

The foregoing instrument was acknowledged before me this 4<sup>th</sup> day of MAY, 2007, by:

The foregoing instrument was acknowledged before me this 4<sup>th</sup> day of MAY, 2007, by:

CAROL AGOSTINI

DAVID M. PIAIA

as a free and voluntary act and deed.

as a free and voluntary act and deed.

Witness my hand and official seal.

Witness my hand and official seal.

My commission expires: 10-10-09

My commission expires: 10-10-09

*Susan Romango*  
Notary Public

*Susan Romango*  
Notary Public

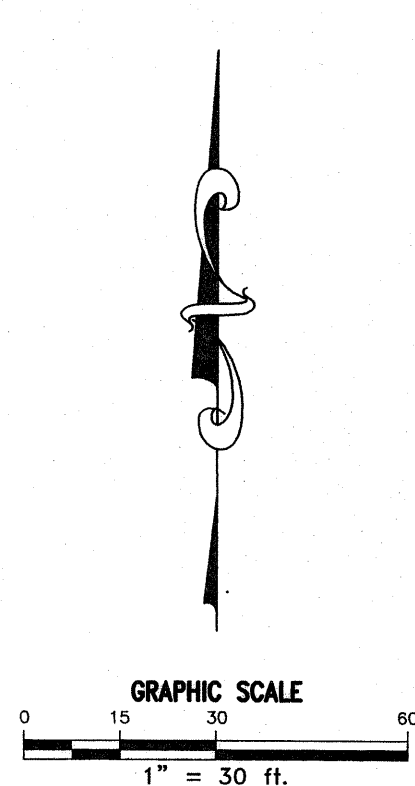
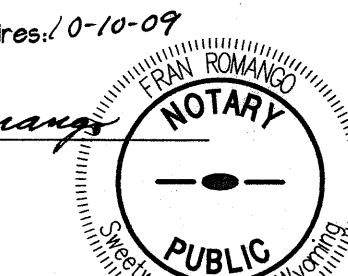
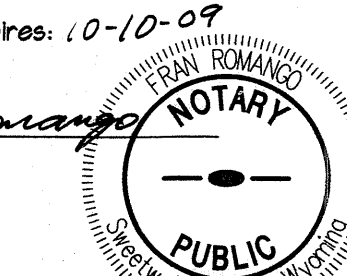

NOTE:  
THIS SUBDIVISION INCLUDES A TOTAL OF 2 LOTS AND CONTAINS A TOTAL OF 0.631 ACRES.

MAINTENANCE AND UPKEEP OF DRAINAGE EASEMENTS WILL BE THE RESPONSIBILITY OF THE INDIVIDUAL LOT OWNER. FENCES, WALLS OR FOOTINGS THAT WOULD IMPEDE DRAINAGE FLOWS WITHIN THOSE DRAINAGE EASEMENTS AND REGRADING OF DRAINAGE EASEMENTS SHALL NOT BE PERMITTED.

BASIS OF BEARING  
THE BASIS OF BEARING IS SOUTH 87°49'05" EAST ALONG THE NORTH LINE OF FEDERAL LOT 2.

DEVELOPERS  
CAROL AGOSTINI REVOCABLE TRUST  
2828 COLIMA DRIVE  
ROCK SPRINGS, WYOMING 82901  
Phone: (307) 382-4700  
DAVID M. PIAIA  
2212 MOUNTAIN ROAD  
ROCK SPRINGS, WYOMING 82901  
Phone: (307) 389-1062

LEGEND  
● 3-1/4" BERNTSEN ALUMINUM CAP WITH 2-3/8"x30" ALUMINUM PIPE STAMPED "QUINELLA BOUNDARY (Corner # marked on drawing)", SET THIS SURVEY.)  
○ INDIVIDUAL LOT CORNERS TO BE MONUMENTED WITH A 5/8" REBAR WITH ALUMINUM CAP STAMPED "PROPERTY CORNER JFC PLS 2928".

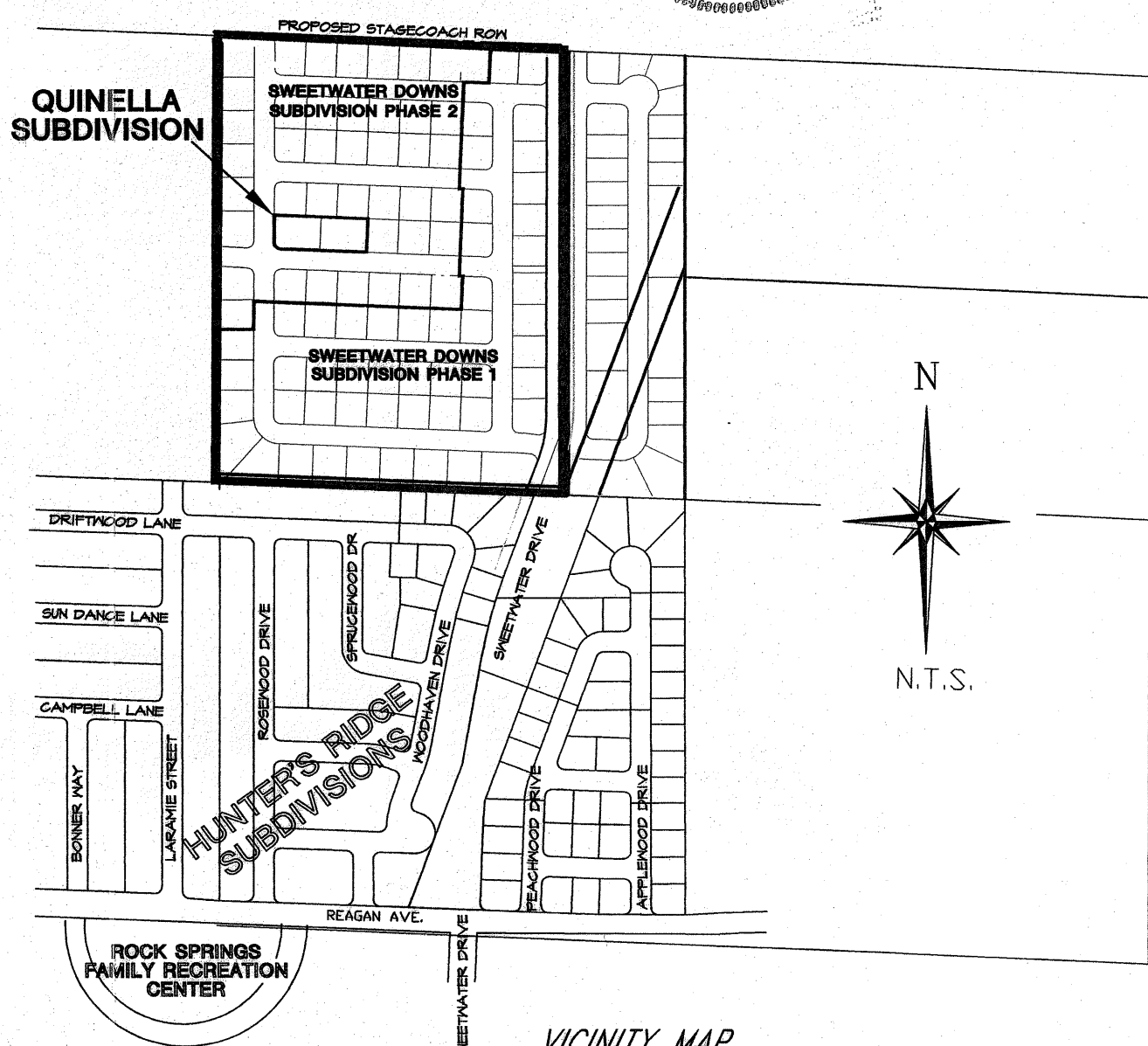

FILE NAME: P:\N\A\Draws\7812781.dwg [DWG] PLAT--rec'dwg, 27 APR 07 16:32

RECORDED 5/18/2007 AT 12:28 PM REC# 1503184 B\*# 0000 P## 0000  
STEVEN DALE DAVIS, CLERK OF SWEETWATER COUNTY, WY Page 1 of 1